

Inner Mainframe

Table 4-3. Inner Mainframe

Item	Description	Part Number
1	Plate CC	01090-04104
2	Screw M3×0.5 - 6lg	0515-0536
3	Screws	1251-7788
4	Cover Rear <i>ALS</i>	01090-04122
5	Plate Rear <i>Series I ALS</i>	01090-04121
	Plate Rear <i>Series II ALS</i>	01090-04145
	Plate Rear <i>Series I TCAS</i>	79847-04106
	Plate Rear <i>Series II TCAS</i>	79847-04111
6	Panel HP-IB	01090-00202
7	HP-IB Interface Cable/Board (incl. items 6, 15)	01090-66504
8	Switch	3101-0402
9	External Contacts Interface	01090-66526
10	Screw M5×0.8 - 10lg	0515-0561
11	Fuse F1, 4A 220V	2110-0055
	Fuse F1, 8A 120V	2110-0342
	Fuseholder Cap	2110-0565
	Fuseholder	2110-0566
	Fuseholder Nut	2110-0569
12	Screw M3×0.5 - 8lg	0515-0570
13	Line Filter 220V	9135-0038
	Line Filter 120V	9135-0202
14	Rear Panel	01090-00206
15	MTG Stud	0380-0644
16	Capacitor 3 μ F \pm 10% 220V	0160-5712
	Capacitor 10 μ F \pm 10% 120V	0160-5713
17	Screw M3×0.5 - 6lg	0515-0536
18	Power Switch Cable	01090-61606
19	Oven Primary Cable	01090-61607
20	Screw M5×0.8 - 10lg	0515-0561
21	Pump Primary Cable	01090-61609
22	Detector DC Supply Cable	01090-61605

Table 4-3. Inner Mainframe (continued)

Item	Description	Part Number
23	Screws	0515-0898
24	Plate	01090-04116
25	Pressure Signal Cable	01090-61611
26	Screw M5×0.8 - 80lg	0515-0204
27	Washer	2190-0587
28	Power Transformer	01090-61103
29	Insulation Detector	4040-2152
30	Filter	3150-0462
31	Label Oven <i>Series I</i>	01090-00508
	Label Oven <i>Series II</i>	01090-04141
32	Plate Side	01090-04112
33	Screw M3×0.5 - 6lg	0515-0536
	PCB Guide orange (for ISD slot)	5040-4629
	Screw M3×0.5 - 10lg (for securing CTM to mainframe)	0515-0538
	PCB Guide (for PWR, PSC slot)	0403-0102

Note

For DC fan parts, see Table 4-4. For AC fan parts, see Table 4-5.

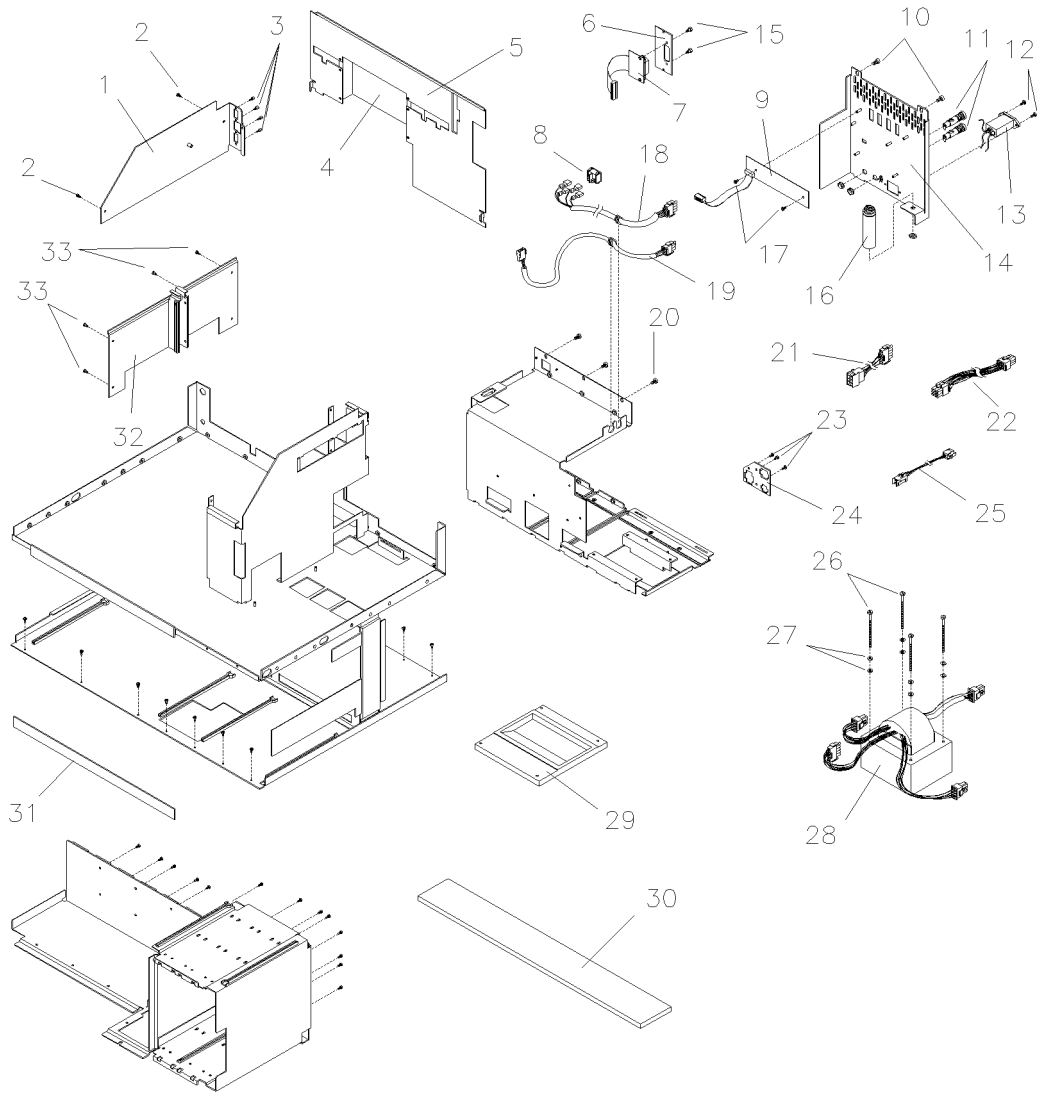

Figure 4-3. Inner Mainframe